

STRONGER

TOGETHER



ANNUAL REPORT 2020-2021

SARASOTA MEMORIAL
HEALTHCARE
FOUNDATION

STRONGER
TOGETHER

Our community. Our hospital. Our healthcare.

Dear Friends and Supporters,

If last year was considered an unprecedented year, this year could be described as remarkable. While the pandemic persisted, so did the unwavering support of our donors. Amid ongoing challenges, the strength of our community propelled our mission forward. In fiscal year 2021, the Healthcare Foundation was able to raise over \$23.5 million to help fund patient care initiatives, lifesaving technology, new and upgraded facilities, clinical staff education and research programs at Sarasota Memorial.

What was already an outstanding year of growth was amplified by a \$10 million gift from Brian and Martha Cornell in support of the creation of a new behavioral health pavilion at SMH. This heartfelt gift shines a light on the importance of having comprehensive behavioral healthcare for those in our community in need of support.

This was also the year that two of our signature events were moved to a virtual platform. While the pandemic did not allow us to be together, it didn't stop our sponsors and supporters from making The Hospital Gala and Women & Medicine big successes once again.

We are so grateful for your continued support and commitment to our mission.



Mason Ayres, CFRE, CFP®
PRESIDENT

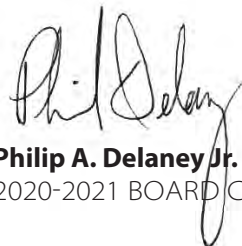

Philip A. Delaney Jr.
2020-2021 BOARD CHAIR



FUNDRAISING

- 04 Highlights
- 06 Initiatives
- 08 Signature Events

GRANTS

- 12 Fulfilling Our Mission
- 13 Grants Awarded

FINANCIAL POSITION

BOARD OF TRUSTEES

DONORS

- 16 Corinthian Society
- 21 EPIC
- 24 Legacy Society
- 26 Annual Gifts

Amid ongoing challenges, the strength of
our community propelled our mission forward.
Together we strengthen healthcare.

Fundraising Highlights

2020 – 2021

As the pandemic continued to affect our everyday lives, forcing teams to work remotely and event plans to pivot, our supporters continued to rally around Sarasota Memorial Healthcare Foundation and Sarasota Memorial Health Care System. This year, more than \$23.5 million was donated to the Healthcare Foundation.

Since the pandemic began, the generosity of supporters has provided Sarasota Memorial with critical resources that helped SMH care for COVID-19 patients, as well as all other patients who required care during this time. COVID-19 grants directly supported frontline workers and their efforts to combat the delta variant surge.

This year's fundraising culminated with a \$10 million gift from Brian and Martha Cornell in support of a

new behavioral health facility at SMH-Sarasota. In recognition of their gift, the new facility will be named the Cornell Family Behavioral Health Pavilion and will break ground in spring 2022.

Three of our popular signature events returned to entertain and educate our guests while raising funds for crucial services at SMH. In January 2021, The Hospital Gala was livestreamed to hundreds of guests and raised over \$900,000 for SMH's greatest needs. In March, the Women & Medicine Educational Luncheon was held virtually and raised funds to help SMH purchase a new bone density scanner. Additionally, we returned to the links in May for the 19th annual Golf Tournament, hosting a record number of golfers and volunteers.



Brian and Martha Cornell donate \$10 million in support of a new Behavioral Health Pavilion at SMH.



Cornell Family Behavioral Health Pavilion

One of the Healthcare Foundation's major initiatives this year focused on supporting SMH's vision for a new behavioral health facility and expanded services at a time when COVID-19 has disrupted lives and led to an increase in people struggling with mental health challenges.

Target Corp. Chairman and CEO Brian Cornell and his wife, Martha Cornell, donated \$10 million to support the creation of the Behavioral Health Pavilion at SMH. The gift will help fund a new state-of-the-art behavioral health pavilion offering comprehensive in- and outpatient mental health services, filling an immense community need for convenient, comprehensive care under one roof.

By supporting the Behavioral Health Program at SMH, the Cornells' gift will make a huge impact in an area that is often underserved yet affects countless families every day. The Cornells' goal is to help provide the best care to community members in need and help break the stigma attached to mental illness.

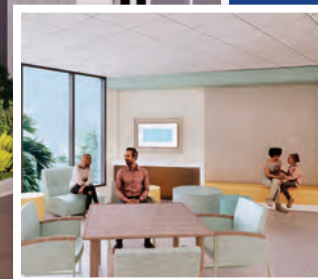
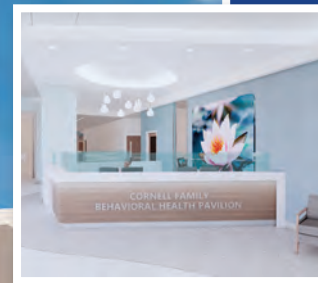

Fundraising Initiatives

2020 – 2021

Sarasota Memorial Hospital-Venice

At the end of this fiscal year, SMH-Venice neared completion. The new hospital and medical campus in Venice will provide local residents with the same level of excellent medical and patient care they have come to expect from SMH, closer to home.

The new hospital has 110 private patient suites, eight surgical suites and the full array of hospital services, including a 28-room Emergency Care Center, Cardiology, Orthopedics, Intensive Care and a comprehensive Labor and Delivery/Postpartum Unit.

Gifts to the Healthcare Foundation will fund programs, services and facilities at the new hospital.





The Brian and Sheila Jellison Family Foundation has helped make SMH's vision of comprehensive cancer care a reality.

Leading with Care Cancer Campaign and the Brian D. Jellison Cancer Institute

At the end of this fiscal year, the Brian D. Jellison Cancer Institute Oncology Tower at SMH neared completion. The Healthcare Foundation's *Leading with Care* fundraising campaign is helping make SMH's vision of comprehensive cancer care a reality. The campaign has raised over \$56 million toward our \$75 million goal, which will support the four phases currently planned for the Jellison Cancer Institute.

Phase one, the Radiation Oncology Center at University Parkway, opened to patients in August 2020, and phase two, the inpatient and surgical oncology tower on the Sarasota campus, is on schedule to open in November 2021.

Our campaign continues as planning for the next phase has begun and includes an outpatient Cancer Pavilion on the SMH-Sarasota campus.



Signature Events

2020 – 2021

\$1.21M+

TOTAL RAISED THIS YEAR

1,000+

ATTENDEES





The Hospital Gala

JANUARY 2021

The Hospital Gala is one of the area's premier fundraising events, raising over \$4.3 million since its inception to support Trauma, Cardiac and Cancer Services.

This year, the fourth annual Hospital Gala was held virtually and livestreamed from the Ritz-Carlton, Sarasota, to hundreds of guests. The entertaining evening featured a talk-show format with videos, a donation phone bank, and a performance by The Royals, and culminated in a virtual paddle-raise bringing in just over \$900,000 for SMH's areas of greatest need.

\$900K+
RAISED THIS YEAR

\$4.3M
RAISED TO DATE





\$150K

RAISED THIS YEAR

\$687K

RAISED TO DATE

**WOMEN &
MEDICINE**
EDUCATIONAL LUNCHEON
SARASOTA MEMORIAL HEALTHCARE FOUNDATION

Women and Medicine

MARCH 2021

The eighth annual Women & Medicine Educational Luncheon was streamed to over 300 guests. The event, themed “566 Things Women Should Know About Aging Gracefully,” focused on bone and joint health, raising over \$150,000 for Orthopedics and Rehabilitation Services at Sarasota Memorial. Proceeds helped SMH purchase a new bone density scanner.

The educational program was moderated by Stephanie Roberts, co-host and producer of *Suncoast View ABC7*, and included a panel of bone and joint experts, including Julie Gladden Barré, M.D., Sports Medicine and General Orthopedics; Kelly J. Hamel, M.D., Gynecology and Obstetrics; and Sarah Wengert PT, DPT, Sarasota Memorial Rehabilitation Pavilion.





The Golf Tournament

MAY 2021

A record number of golfers, 232, teed off at the 19th annual Golf Tournament, held at Laurel Oak Country Club. The tournament raised \$170,000 this year—and over \$1.1 million to date—to support the Sarasota Memorial Hospital Physicians Endowment, which provides continuing education opportunities for our health system staff and gives them the opportunity to earn new certifications and update existing credentials.

The tournament is an annual collaboration of local businesses and individuals who support the event through sponsorships and participation in the tournament. More than 90 volunteers were also on hand to help make the event a rousing success.

\$170K

RAISED THIS YEAR

\$1.1M

RAISED TO DATE



Fulfilling Our Mission

2020 – 2021

99

GRANTS AWARDED

\$8.7M+

TOTAL AWARDED

Strengthening Healthcare

This year, the Healthcare Foundation awarded more than \$8.7 million in grants to Sarasota Memorial and other community health organizations in crucial areas such as women's cancer research and breast health, COVID-19 support, clinical staff education and scholarships, indigent care and medical services for the underinsured, medical facility improvements and equipment, employee wellness programs and behavioral health.

With these grants, SMH established an apheresis program and a cardiac nurse navigator program and purchased orthopedic surgical tables, GE Giraffe Omnibed Carestations for the NICU, echo ultrasound machines, colonoscopes and a Panther Instrument

system for COVID-19 testing. Over \$958,000 was awarded to renovate the Electrophysiology Lab in the Cardiac Cath Lab and another \$845,000 to renovate the SMH pharmacy and purchase an automated pharmacy storage system.

The Healthcare Foundation also awarded \$50,000 to First Step of Sarasota to help support the Behavioral Health Response Team and reduce emergency room admissions. The program provides around-the-clock intervention to Sarasota residents and families experiencing a mental health or substance use crisis.

We would not have been able to provide these grants without the generosity of our community.



TECHNOLOGY
\$3.6M



PATIENT CARE
\$1.9M



FACILITIES
\$1.5M



RESEARCH
\$1.3M



EDUCATION
\$491,328

Grants Awarded

October 1, 2020 – September 30, 2021

Apheresis Equipment

\$188,884

Behavioral Health Program Support

\$65,000

Blood Drives

\$19,800

Breast Health Diagnostics,
Reconstruction – Patient Resources

\$117,276

Cancer Institute Support

\$79,064

Cancer Research

\$120,000

Cardiac Lung Assist Units

\$210,630

Cardiac Navigator Program

\$1,000,000

Cardiovascular Ultrasound Equipment

\$450,000

Community Specialty Clinic

\$200,000

COVID-19 Support

\$495,161

Education & Professional Development

\$254,478

Electrophysiology Lab Renovations

\$958,856

Employee Health & Wellness

\$37,765

Endoscopy Equipment

\$132,900

Facilities Improvements

\$139,041

Functional MRI System

\$285,000

Indigent Care Support

\$38,000

Mammograms, Screening,
Diagnostics – Underinsured

\$25,000

Multi-media Studio

\$300,000

NICU Giraffe Bed Systems

\$253,000

NICU Medfusion Pumps

\$110,230

Operating Room Tables

\$112,151

Patient Care – General

\$140,161

Patient Care – Equipment

\$553,383

Pharmacy Renovation &
Automated Storage System

\$845,000

RENEW Community Health
Program Support

\$117,000

Scholarships

\$249,900

Women's Cancer Care
Research Program

\$1,300,000

Total Grants Awarded

\$8,797,680

Financial Position

October 1, 2020 – September 30, 2021



Assets

\$10,761,325	Cash and Cash Equivalents
\$58,681,503	Investments
\$243,641	Prepaid Expenses and Other Current Assets
\$28,232,494	Pledges Receivable, Net
\$11,484,329	Bequests Receivable
\$383,098	Contributions Receivable from Charitable Trusts
\$153,350	Assets Held in Charitable Trusts and Annuities
\$1,083,893	Beneficial Interest in Perpetual Trusts
\$95,871	Furniture, Fixtures and Equipment, Net
\$111,119,504	Total Assets

Liabilities

\$330,674	Accounts Payable and Accrued Expenses
\$10,239,757	Grants Payable
\$415,583	Deferred Revenue
\$42,079	Annuities Payable
\$113,094	Liability Under Trust Agreements
\$11,141,187	Total Liabilities

Net Assets

\$14,195,656	Without Donor Restrictions
\$76,577,095	WITH DONOR RESTRICTIONS:
\$9,205,566	Purpose and Time Restrictions
	Perpetual in Nature
\$99,978,317	Total Net Assets

Board of Trustees

2020 – 2021

OFFICERS

Philip A. Delaney Jr.
CHAIR

William E. Chapman II
IMMEDIATE PAST CHAIR

Michael J. Valentino
VICE CHAIR

Richard Gerrity
TREASURER

Gwen MacKenzie
SECRETARY

EXECUTIVE COMMITTEE MEMBERS-AT-LARGE

Mary Evelyn Guyton

Deb Kabinoff

Jonathan E. Mitchell

Joel Morganroth, M.D.

Robert L. Wood

MEMBERS

Robert G. Bartner

Ariane M. Dart

Gary F. Dornbush

John Giglio

Eric Kaplan

Thomas F. Kelly, M.D.

Robert P. Martin

Diane M. Mayer

Barbara Rodkin

Eric Spiegel

Sandra Stuart

David Verinder (Ex Officio)

Kirk G. Voelker, M.D.

Margaret Wise





The Corinthian Society is composed of those who made or pledged cumulative gifts of \$25,000 or more.

Corinthian Society

October 1, 2020 – September 30, 2021

NEW MEMBERS ARE IN BOLD

VISIONARY \$10,000,000+

Brian and Martha Cornell

Brian and Sheila Jellison Family Foundation

Anonymous

CAPITAL \$1,000,000+

Anonymous

M. Beverly and Robert G. Bartner

The Bolger Foundation

Dart Foundation

Miss Jane C. Ebbs

Louis and Gloria Flanzer
Philanthropic Trust

Keith G. Hirst

Carolyn Thurston Holden

Leona Hughes

The Janet & Stanley Kane Family

Searcy G. Koen Trust

Mrs. Elizabeth E.G. Mann

Mrs. Philip P. Marvin

Harry O. and Alwena Mayer

Susan F. Milman

Edward D. and Anna Mitchell
Family Foundation

Mr. and Mrs. L. Sanford Reis

Gary and Barbara Rodkin

Samowitz Foundation

Sarasota Memorial Hospital
Auxiliary, Inc.

Helen Schacht

Dr. and Mrs. Ralph W. Shrader

Mrs. Charlotte Siks

The Harry Sudakoff Foundation

Roberta Leventhal Sudakoff Foundation

KEYSTONE \$500,000+

Mr. James C. Alexander

Anonymous

Charles & Margery Barancik Foundation

Francine Joyce Blum

Boar's Head Brand

Breast Health Sarasota, Inc.

Mr. Henry Cape

Douglas and Sharyn Chapman

Pleasants D. Coggeshall

Anonymous

Dr. and Mrs. Hanns R. Ehrhardt

Mrs. Helen S. Enterline

Jean and Alfred Goldstein

Mary Ernestine Hart

Mr. and Mrs. Howard Isermann

Elizabeth S. Lewis

Ms. Karen S. Matteson

Marianne and William L. McComb

Jim Meekison and Carolyn Keystone

Mrs. Lillian A. Meckler

Anonymous

Rickie and Jana Paley

Gladys Parkin

Winfield & Mildred Ramsdell Trust

Mr. Jack Rohner

Mrs. Ellen M. Sickmeier

Mr. Herbert G. Wile

PILLAR \$250,000+

Anonymous

Robert and Willa Bernhard

Bini-Scarborough Family Fund

Boscia Family Foundation

Emmett J. Brennan

Joan and Dik Browne

Carol and Les Brualdi

The Burruss Foundation Trust

Teresa and Charlie Cannon

Mr. and Mrs. William E. Chapman II

Cyrus B. and Lena Alaire Cook

Margot E. and Warren J. Coville

Eliza and Hugh Culverhouse

Linnie E. Dalbeck Memorial Foundation

John H. and Alida J. de Jongh

Mr. and Mrs. Paul Eckel

Lawrence P. and Carol M. English

Mr. John R. Fitzpatrick

Beatrice Friedman

Mrs. Bernadine Haman-Sponzilli

Intertape Polymer Group

Ms. Margaret M. Irwin

Michael V. Janes Non-Grantor
Charitable Lead Annuity Trust

Dr. and Mrs. Glenn F. Kiplinger

Jeffrey and Susan Jones

Deb Kabinoff

Kosloski Family Foundations

Anonymous

Harold L. Libby and Wanda Rayle-Libby

Flora Major for the
Kutya Major Foundation

Adrienne J. Matcham

Judith H. Melly and L. Thomas Melly

Northern Trust

Blanche N. Oberhaus

Mrs. Eleanor B. Pepion

Lee and Bob Peterson

Anonymous

Mrs. Eluned W. Russell

Sam Samelson

Sarasota Memorial Health Care System

Mr. Oscar Scheffler

Ms. Helen Scherer

Mark and Paula Schleicher

Mildred and Donald Stein

Frank N. Tedesco,
Charitable Remainder Unitrust

Heidi Turner

James and Toni Turner Foundation

Michael and Karen Valentino

Jean Weiller

Mr. and Mrs. William L. Weiss

Williams Parker-Attorneys at Law

PEDESTAL \$100,000+

Harvey J. and Marcia K. Abel

Amicus Foundation, Inc.

Anonymous

Anonymous

David S. and Myrna L. Band

Harry and Harriet Bernbaum

Estate of Marjorie Brett Boulware

Charles and Turner Broll

The Julia Burke Foundation

Care Institute Group, Inc.

Arthur and Irene Cash, Charitable Trust

Mr. and Mrs. Thomas J. Charters

Mrs. Luigia A. Ciccarelli

Betsy & Ed Cohen/Aretê Foundation

Kevin J. and Helen V. Collins

Ray and Jeanne Conrad

Marvin and Betty Danto
 Ariane Dart
 Audrey Rau Dempsey Endowment
 Mr. Ralph Diehl
 Mr. and Mrs. Richard O. Donegan
 J. Robert Donnelly and
 Mary Jane Donnelly Charitable Fund
 The Frank J. and Lenora DuPuis Foundation
 Dr. and Mrs. Mahfouz El Shahawy
 Mrs. Dorothy S. Emmert
 Florida Cancer Specialists &
 Research Institute
 Anonymous
 Bob and Joan Geyer
 Mr. and Mrs. Franklyn Gorell
 The Grain Family Foundation
 Charlotte P. Graver
 The Greenfield Foundation
 Gresham Smith
 The Poul Hansen Family
 Ms. Ethyle Harris
 William and Marjorie Hiron
 Marie L. Hoffberg
Steve and Lila Huse
 Finis Gerald and Katherine Jester
 Johnson & Johnson
 Mrs. Evalyn M. Sadlier Jones
Mr. Gary Jones
 Jones Family Foundation
 Arthur S. Karp Family Foundation, Inc.
**Victor M. Kaufman and
 Elizabeth Ann Rainey**
 Ed and Elaine Keating
 Drs. Jacqueline and Thomas Kelly
 Mr. Loma B. Kennedy
 Mrs. Paul Klingenstein
 Walter P. and Grace H. Lantz
 The LeBaron Foundation

Louis and Sandra Levy
 Dr. Charles and Mrs. Lisa Loewe
 D.R. Long Foundation
 Jim Meister
 Joan Armour Mendell Foundation, Inc.
 Mr. Jo Zach Miller, IV
 Joel and Gail Morganroth
 Ron Morris Family Foundation
 Gloria Moss
 Dr. and Mrs. Kevin W. O'Neil
 Colonel Ernest Ogram
 Susanne C. Olin
 Anonymous
 Anna Mae Pasqua
 Mrs. Lois J. Perry
 Leonard A. Pierson and
 Bessie M. Pierson, Unitrust
 Mrs. Ingeborg Ralston
 Jerry Rand
 Thomas and Jane Rattigan
 Donald T. Regan Charitable Foundation, Inc.
 Peter and Nancy Reinheimer
 Ruth G. Rolfe
 Harold R. Ronson
 Alfred Rose
 Donald and Joy Rowe
 John B. Rutledge,
 Charitable Remainder Unitrust
 Saks Fifth Avenue
 Sarasota Medical Foundation
 Laurence Saslaw
 Michael Saunders & Company
 Mr. and Mrs. Charles R. Savidge
 Chuck and Chris Shivery
 Allan and Isabel Silverman
 SKANSKA
 Dan, Rob and Mike Snyder, Founders of
 The Patricia Snyder Golf Tournament

Harry O. Specht, M.D.
 Bill and Judy Stanford
 Donna Wolf Steigerwaldt Foundation
 Norma and Hugo Stein
 Dee and Charles Stottlemeyer
 Michael and Robin Strauss
 Robert L. Stuffings
 Dr. and Mrs. Christopher C. Swain
 Jim and Charlie Ann Syrett
 Tarr Charitable Family Foundation, Inc.
 Joyce Tate
 Marcia Jean Taub in loving memory
 of Ethel and Ron Taub
 Mrs. Beatrice R. Thompson
 James and Susan Tollerton
 Bill and Rebecca Tompkins
 Tom Towler and Nancy Lyon
 Mrs. Howard W. Trevey
 Anonymous
 Frances G. Van Gorder Estate
 Bernard W. and Maureen Walsh
 Elisabeth Waters
 Ms. Barbara Whitcraft and
 Mr. David Heinsler
 Elton and Gordie White
 Steven White
 The Edward and
 Ruth Wilkof Foundation
 Jason & Nancy Wilson
 Edie Winston
 Margaret Wise
 Marilyn Wolff,
 Charitable Remainder Unitrust
 Peggy and Art Wood
 Angelia and Robert Wood
 Mrs. Frances Wormser
 Judy Zuckerberg and George Kole

DOCTOR OF PHILANTHROPY \$50,000+

Gerri Aaron
 Drs. George and Janet Allgair
 Ambitrans Ambulance
 Bank of America
 Bank of America Client Foundation
 Anonymous
 Bernbaum Family Charitable Fund
 Mr. and Mrs. Carlos Beruff
 BMO Financial Group
 Mr. and Mrs. Robert D. Bohan

Bohrer Family Charitable Foundation

Mr. and Mrs. Paul S. Bomberger
 Mrs. Evalina Booth
 Mr. Robert I. Broida
 Travis and Kathy Brown
 Dr. and Mrs. Richard H. Brown
 Harriet Brush
 Community Foundation of
 Sarasota County
Kathy and Colin Cornhill
 Eileen and Howard Curd
 DeAngelis Diamond Construction, LLC
 Mrs. Eleanor S. Devlin
 Marjorie L. Dixon
 Douglas Jeep Chrysler Dodge Ram
 The Frank E. Duckwall Foundation, Inc.
 Mr. Max Edwards
 Betty and Charles Ewing
 Jan and Bill Farber
 Frank and Christa Fineshriber
 G. Duncan Finlay, M.D., and
 Michele Wolk, MSN
 FLAD Architects
 Sally Gambling
Mr. Melvin A. Gang
 Getzen Family Charities, Inc.
 Mr. Eldon H. Gleaves

Mary Jean Glidden-Williams
 Marian Y. Goble
 Mrs. Ruth Gorton
 Gulf Coast Community Foundation, Inc.
 Annette Van S. Hallowell
 Irrevocable Trust
 Renee Hamad
 Mrs. Joanne S. Hastings
 Edna and Richard Hausman
 Anonymous
 Casiana and Barry Hilton
 Auerbach Hirsch Memorial Fund of the
 Menorah Legacy Foundation
 Browning & Ruth N. Holcombe,
 Charitable Remainder Unitrust
 Doug and Carolyn Ann Holder
 Dr. and Mrs. Franz Hummert
 Janice S. Kelly Memorial Foundation
 JCI Jones Chemicals, Inc.
 Mr. Richard S. Johnson
 Gregory and Carol Ann Kalish
 KBR Foundation, Inc.
 Katherine M. Keeley, M.D.
 Mr. Lewis O. Keith
 Ms. Mary Kendall
 Mr. Roger Knapp and the William C. Knapp
 Charitable Foundation
 The Knox Family Foundation
 B. Brand Konheim Private
 Charitable Foundation
 Mr. Samuel A. Kott
 Mr. and Mrs. Robert Kramer
 Ruth B. Kreindler
 LeeSar Regional Service Center
 Frederick and Janet Leonberger
 Mr. and Mrs. Robert L. Loretan
 Mr. and Mrs. Robert Lumpkins
 Doris M. Lyons
 James and Lorna Mack

Doug and Gwen MacKenzie
 Drs. Marguerite and T. Logan Malone
 Miss Louise E. Mathews
 Shirley Rae Miller
 Mr. and Mrs. Jonathan Mitchell
 Larry R. and Priscilla R. Mitchell
 Mr. William R. Mote
 Mrs. Irmgard G. Nicotera
 Jim and Alice Padilla
 Mrs. George K. Page
 Joseph Persky Foundation
 Mr. Henry J. Peters
 PNC Wealth Management
 Preceptor Theta Sigma
 Chapter of Beta Sigma Phi
 Dr. Larry Press & Mrs. Lisa Keverian-Press
 Rose Marie Proietti
 Radiology Associates of Florida, PA
 RBC Wealth Management
Mr. Frank J. Rich
 Mrs. Mary Ann Robinson
 Anonymous
 Mr. Robert and Dr. Sherry Rogers
 Mrs. Elaine Rothenberg
 Richard and Gail Rubin
 Varda and Uzi Ruskin
 Mr. Julien M. Saks
 Mr. and Mrs. John E. Sandefur
 Sarasota Emergency Associates
 Mary and Buddy Savary
 Savidge Family Foundation
 Mr. Herbert H. Schiff
 Mr. and Mrs. David M. Schneider
 Katharina and Joseph Schober Foundation
 Robert and Barbara Schwartz
 The Tillie, Jennie & Harold Schwartz
 Foundation, Inc.
 Lorraine and Richard Schwarz
 Family Foundation

William G. Selby and
 Marie Selby Foundation
 Sertoma Club of Greater Sarasota, Inc.
 Mr. and Mrs. Bud Shapiro
 John & Catherine Shuler,
 Charitable Trust
 Mike and Renee Silverstein
 SMH Radiology Associates, P.A.
 Mr. Sterling W. Smith
 Dr. and Mrs. J. Robert Spencer
 Sunset Automotive Group
 Anne O. Swain
 Bibb and Pamela Swain
Cheryl and Melvin Taub
 Sylvia and James Taylor
 Team Tony Cancer Foundation, Inc.
 Virginia B. Toulmin Foundation
 David and Monica Verinder
 Mr. and Mrs. Peter Wasserman
 Mr. Charles Watkins
 Mrs. Theodore T. Watson
 Mrs. Teresa J. Weill
 Mrs. Judy White
 Seymour White
 Mr. Charles F. Wiebusch
 Bill and Cheryl Woeltjen

PATRON \$25,000+

Abbott Laboratories
 Mrs. Donald T. Aikenhead
 Don and Peggy Jo Albertson
 Mr. G. William Allaman
 Allegiance Fundraising Group
 Mr. David S. Allen
 Carol and Morton Allen
 G. Leonard Apfelbach, M.D.
 APG
 Mason and Anne Ayres
B & I Contractors, Inc.

Bank of America Client Foundation-
 Virginia White Clark Fund
 Bank of America Client Foundation-
 Richardson Foundation Fund
John H. Barber and Myrtle F. Barber
 Mrs. Theodore R. Bartels
 Mr. and Mrs. Walton Beacham
 Mr. and Mrs. Eugene H. Beckstein
 William J. Bengel
 Linda and Bill Berliner
 Mandell and Madeleine
 Berman Foundation
 Sharon Black Floyd
 Charles and Nancy Blackburn
 Mrs. Althea Blake
 Mrs. Mildred J. Bloom
 Borrell Electric Co., Inc.
 Brasfield & Gorrie
 Mrs. Jaclyn K. Brunckhorst
 Calusa Lakes Women's Golf Association
 The Kathleen K. Catlin Foundation
 Dr. John W. Carrier
 Charles Perry Partners, Inc.
 The Edward H. Butler Foundation
 E. Boyer and Irene L. Chrisman
 Citi
 Richard N. and Cynthia Clark
 Coastal Property Group of Florida, Inc.
 Cool Today
 James D. Corbett
 John Crichton and Chantale Langlois
 Dorothy E. Croft
 John and Christine Currie
 LeRoy Robert Dapper and Susan Jane
 Dapper
 Mrs. Margaret Davis
 Mr. and Mrs. Philip A. Delaney Jr.
 Deupree Family Foundation
 Ruth Dexheimer

Dimensional Insight, Inc.
 Gary and Carol Dornbush
 Mr. and Mrs. Clifford Drake Jr.
 Ms. Theresa Duble
 Mrs. Edith Barr Dunn
 Brian and Caroline Ellerson
 Marion E. Erlandson
 Janet and Denis Evans
 Mrs. Louis T. Falcone
 Mrs. Zola Felton

Mildred R. Field

Financial Corporation of America
 Martin L. Fine Family

Dr. and Mrs. James Fiorica

Ms. Wendi Fogelson and Mr. Ed Mills

Andrew J. and Anita G. Frankel Family
 Foundation, Inc.
 Herman and Sharon Frankel Foundation
 Fraternal Order of Eagles #2756
 Ladies Auxiliary
 Audrey B. Frush
 Ronald Gamer
 Dottie Baer Garner
 The GE Foundation
 Coworkers of William Genneken

Mr. and Mrs. John R. Giglio

Gilbane Building Company
 Mr. William G. Goodnow

Mr. William A. Granberry

Mr. and Mrs. Irwin Greenwald
 GTE Florida, Inc.
 Hammes Company
 Mr. William T. Harrison Jr.
 Hautamaki & Horiuchi -
 Personal Physicians of Sarasota
 Janet E. Hevey
 Mr. and Mrs. Malcolm M. Hirsh

Dr. and Mrs. Jonathan D. Hoffberger

Mrs. Mollie Holland

The Hurlburt Foundation Inc.
 IBERIABANK
 Illinois Tool Works Foundation
 George S. and Barbara Ives
 J2 Solutions Inc.
 Philip and Edina Jennison
 Bill and Mary Lou Johnson
 Mr. and Mrs. Brian Johnson
 Phil and Unni Kaltenbacher
 Mrs. Dorothy Kavanagh
 Wendel F. Kent
 King Features
 Marcy and Michael Klein
 Charles Knowles
 Koski Family Foundation
 Ms. Ashley D. Kozel
 Krafur Family Foundation
 LaGasse Plumbing
 Rita B. LaMere Memorial Foundation
 Moses and Pat Lane
 The Philip and Janice Levin Foundation

Dr. Horace and Mrs. Lorrie Liang

Carol K. Longley

Mr. Terry J. Lundgren

Lung Associates of Sarasota
 David and Susan Macrae
 Mrs. Henry G. Maeder
 Peggy A. March, M.D.

Richard and Diane Mayer Family Fund

Jeanne Mather
 Jan and Bill Mauck
 H. Gladstone McKeon Foundation
 The Meadows Country Club

Meisner Electric, Inc.

Dr. and Mrs. Joseph Mendels

The Mennen Company
 Carolyn Michel and Howard Millman
 Lois Rose Miles
 Dr. and Mrs. Frederick L. Moffat

Mrs. Adelaide Moise
 Ms. Elizabeth Moore
 Mr. Gordon C. Morse
 Rick and Nancy Moskovitz
 Margaret Nadler
 National Emphysema Foundation
 Richard and Betty Nimtz
 Anonymous
 Mr. Peter Plotkin and
 Ms. Diane McNeel
 Alexandra Quarles
 Isabelle Reed
 Mr. Ernest F. Rice
 Bob Richardson
 Flori Roberts
 Ms. Amy F. Rode
 Mr. Robert Z. Rosenthal
 The Rubin Charitable
 Foundation, Inc.

Gail and Skip Sack

SaraPath Diagnostics
 Sarasota Anesthesiologists, P.A.
 Sarasota Ford
 Sarasota Plastic Surgery Center
 Sarasota Vascular Specialists
 Reed and Ginny Savidge
 Betty Schoenbaum

SHERLOQ Solutions

Mr. and Mrs. Robert Shlaudeman
 Dr. David and Mrs. Yara Shoemaker
 Dr. Alissa Shulman-Sovereign
 Plastic Surgery
 Shumaker Loop & Kendrick LLP
 Mrs. Virginia M. Sloan
 Estate of Barbara B. Smith
Mary and Steven Smith
 Smith Seckman Reid, Inc.
 Willis A. Smith Construction, Inc.
Eric and Doreen Spiegel

Starlight Children's Foundation
 Stericycle, Inc.
 Mr. Robert K. Strasser
 Mr. and Mrs. Harold Strong
 SunTrust Bank
 SunTrust Bank, Gulf Coast
 Sutter Roofing Company of Florida

Hobart and Janis Swan

Synovus Bank
 Mrs. Iris Tabner
 Tampa Bay Trane
 Rebecca A. Tate
 Henry & Marilyn
 Taub Foundation
 Elizabeth T. Templeton
 Sally and Bob Theis
 Tidewell Hospice, Inc.

Jackie and Glenn Tilton

Greg and Lisa Totten
 John G. & Anna Maria
 Troiano Foundation
 Mr. and Mrs.
 Edward K. Trowbridge
 Arthur W. Trulaske Foundation
 Dr. Kirk and Chris Voelker
 Wachovia Foundation
 Pauline Wamsler
 WebTPA, an AmWins
 Group Benefits Company
 Edith N. Weinberger
 Jacob A. Weiser
 Memorial Fund
 Mrs. Beth R. Welsh
 Mrs. Virginia West
 Mrs. Bessie S. Whitcraft
 Thomas and Ann Wierdsma
 T. Wilson Williamson
 Mr. and Mrs.
 Rudolph F. Zupancic



Employee Partners in Caring (EPIC)

October 1, 2020 – September 30, 2021

Arlene Abiera-Salis
 Elizabeth Ackroyd
 Elizabeth Ahearn Klauder
 Matthew Allen
 Robert Altiero
 Constance Andersen
 Pamela Anderson
 Anonymous
 Melinda Bacallao, PT, DPT
 Svetlana Baiamonte
 Alexander Bajorek, M.D.
 Carol Noah Banach
 Anonymous
 Kelly Batista
 Joshua Baumgard
 Lisa Baumgardner
 Dr. Ashleigh Beachy
 Jodi Beachy
 David Beehr
 Paul and Pam Beitlich
 Deborah Bellas
 Melody Benoit
 Risa and Fred Benoit
 Heather Betancourt
 Caleb Biesinger

Elizabeth J. Blaisdell-Breault
 Anonymous
 Jennifer Bonamer
 Jeanne Bonsall
 Anonymous
 Drew Bookout
 Elizabeth Bornstein
 Paul Boserup
 Mark Boucher
 Marla Dee Boyle
 Veronica Brady
 Audrey and Lewis Brazell
 Deborah Bright
 Debbie Brown
 Justin Brown
 Robert Brown
 Jenny Bulat
 Michelle and Jim Butler
 Krista Byler
 April Campbell, APRN
 Jessica Capparelli
 Daniel Caputo
 Paula Carlson
 James Caron
 Cynthia Carr

EPIC is a campaign dedicated to engaging employees of Sarasota Memorial Health Care System and encouraging them to give back to SMH.

Israel Carrasquillo-Cruz	Dana Dorsey	Anonymous	Carol Ann Ivanov	Maria Fe Z. Leonardi
Rosemary Carrico	Sue and Mike Doyle	Susan Grimwood	Rachelle Jackson	Suzanne Lersch
Joanna Carter	Deborah Duff	Angelina Rodriguez Guerrero	Catalina Jekonski	Terri L. Levanti
Terry Cassidy	Patricia Duncan	Tracy Gundrum	Karen Johnson	Keisha Lewis
Judy Ann Cavallaro	Anonymous	Stacey Hafeli	David Jungst	Rohan Lewis
Alexandra Cavallo	Chelee Eaton	Tina Hall	Anonymous	Michelle Lippincott
Ashley Cave	Agostina Eberstein	Shawn Halls	Suellen Kaeb	Lisa Ann Loyet
Pamela Christensen	J.R. Edmiston	Anonymous	Gregory and Carol Ann Kalish	Jean Marie Lucas
John Ciserella	Kitty Edmonds	Anonymous	Bradd Kaplan, M.D.	Amy Lynch
Meredith and Aaron Cleveland	Peg Elbare	Cindy Hardison	Gabrielle Kastor	Laura Machol
Kristie Coleman	Cathy and David Emmett	Valerie Harrelson	Katherine M. Keeley, M.D.	Judy Mack
Teresa Collins	Julie Ennis	Anonymous	Amanda Keenan	Jette Madsen-Nabergall
Lisa Collins-Brown	Michael Ennis	Lisa Haskell	Jill A. Kelly	Laura L. Magnusson
Michele Cook	Sherry Fajura	Severine Haynes	Ms. Monica Kelly	Ticia Mahler
Jessica Coyne	Susan Fallis	Tamara Haynes	Dr. Amanda Kennard	Jennifer Maltby
Chaplain Chuck Creech	Julie Fernandes	Brian Henderson	Lisa Kennedy	Cindy Mang
Tara Cris	Wendy Fisher	Anonymous	Ken and Melissa Kilmer	Nancy Marino
Viki Csepregi	Jennifer Fletcher	Christina Henry	Ronald King	Elaine Markos
Susan Curran	Jeri Floyd	Alice Hicks	Drs. Jamie and Rebecca Kisgen	Karen Marshall
Birdie Curry	Dr. and Mrs. Jonathan C. Fong	Anonymous	Kathy Klimasara	Dale Martin
DeWayne Cusick	Keith Franqueiro	Edward Hoefert	Wendy Kline	Katie Martin
Debra Dallos	Suzanne Freeland	Dr. and Mrs. Jonathan D. Hoffberger	Cheryl Klosterman	Mike Martin, in honor of Robert Martin
Jessica Dalrymple	Mario Gallo	Tanya Hofmann	Mike Klosterman	Lori Mathewson
Anonymous	Jackie Garabito	Anonymous	John Knuth	Anonymous
Christina Debus	Sandra Gary	Ms. Laura Horner	Anonymous	Kimberly McCloughan
Maria DeCarlo	Sarah Gearin	Samantha Hosein	John Kovacic	Anonymous
Tiffany Devore	Roxanne George	Jennifer House	Marilyn Krick	Frank McFarland
Jay DeWitt	Michelle Giacinto	Anonymous	David Kunz	Kent McFarland
Dex Imaging	R.J. Gilgaren	Debra Huffman	Cathy LeBeau	Sandra McFarland
Christine Donnelly	Martha Gonzalez Matala	Anonymous	Laurie LeBoutillier	Debby McGonigle
Kayla Donohue	Heather Graber	Jovan Huss	Katharine LeFrancois	Michelle McGuire
Megan Dorigo	Kimberly Gray	Lisa Hymel	Sarah Lenigan	Bart and Shawn McKee
	Yulonda Greene			

Laura McLeroy	Anonymous	Maaïke Root	Anonymous	Ken Trotter
Mr. and Mrs. Patrick McQuillan	Kathleen Parfitt	Tawnya Roscoe	Karen St. John	Anonymous
Dewayne Meese	David Patterson	Michele Ross	Steve Stapleton	Ivonne Valencia
Jennifer Merritt	Kathleen Pecora	Kelly Rossa	The Starling Group	Sue Vergauwen
Susan Mihm, M.D.	Mark Pellman	Sharon Roush	Dr. and Mrs. Barry I. Stein	David and Monica Verinder
Robert, Maria and Donovan Milano	Michelle Peralá	Marya Rowan	Kristi and Stephen Stetson	Barbara Vickrey
Aimee Miller	Mark Peralta	Keeva S. Russell	Anonymous	Anonymous
Amie J. Miller, APRN	Kimberly Pernia	Kenan and Terry Ryan	Don Stitt	Antonia Vilella
Madelle Miller	Bobby and Aly Pettit	Joanna L. Sabol	Jennifer Storch	Anonymous
Anonymous	Jacquie Pfeiffer	Todd Sak	Geri Storer	Joelle M. Vlahakis, M.D.
Jen Minthorn	Ngoc Pham	Karen Salamone	Heather Story	Nikki Walsh
Mary Mitchell	Rachael Pierce	Robert Salamone	Anonymous	Cam Watt
Maria Moncayo-SantaCruz	Jacquelyn Pietrantone	Robert Santos	Scott Stover	Jack J. Wazen, M.D.
The Moore Family	Mr. and Mrs. Doug Plattner	Michelle Saulnier	Michael L. Sullivan, PA-C	Debra Weingart
Mahira Moreira	Julie Polaszek	Ruth Sawdy	Becky Garcia Sysouvanh	Alexander Wemyss
Cristy Morgan	Carolyn Pollins	Anonymous	Anonymous	Stacie Wenk, D.O.
Jodi Morris	Becky Price	Saralou Butler-Schierloh	Sonja Tarallo	Jeff and Tami Wesner
Joan Moser	Susan Pringle	Sally Schule	Cindy Taylor	Patricia Whalen
Danne and Tish Murphy	Jennifer Prinkey	Anonymous	Kelly Taylor	Robb Wilburn
Joy Nelson	Eric and Jana Putnal	Jeff and Alexis Sergi	Peter Taylor	Catina Wilcox
John D. Nora, M.D.	Quiles Family	Angela Shattuck	Tammy Tedsen	Scott Wilcox
Nothing Bundt Cakes	Laura Quinn	Melissa and Stephen Shelton	Barbara Tello-Accola	Rachel Williamson
Beth C. Nusman	Pamela Ramhofer	Michelle Shirey	Matthew Thomas, M.D.	Kelly Willis
Mary O'Connor	Kathy Reiss	Tony Shultz	Tonia and Rodney Thompson	Sandi Willis
Geff Oakley	Laurie Renfro	Dawn Shultz	Andrea Thornwell	Suzanne Wilson Dumbrell
Anonymous	Dana Rickard	Jason Sierra	Michelle Thurby	Barbara Wingert
Anne Marie Oliveto	Damien Rickwa	Kathy Smith	William Thurby	Bill and Cheryl Woeltjen
Sue and Rich Olsen	Megan Riegling	Kari Snow	Lindsay Tinker	Jennifer Wolfe
Dr. and Mrs. Robert L. Oppenheimer	Tim Rimes	Jessica E. Snyder	Carissa Tomer	Anonymous
Amy Owen	Randy and Cheryl Roberts	Kathryn Snyder	Anonymous	Anonymous
Joannie Padgett	Juan Rodas	Samantha Solie	Greg and Lisa Totten	Anonymous
Ken Parame	John Rodman, M.D.	Charley Spencer-Campbell	Wesley Townsend	Keisha Young
	Joan Rogers, RN, BSN, MSN	Spirit Movers	TJ Tremaine	



The Legacy Society recognizes those who have made a commitment through a will, trust agreement, prepaid life insurance policy or other estate plan vehicle.

Legacy Society

October 1, 2020 – September 30, 2021

NEW MEMBERS ARE IN BOLD

Mr. James C. Alexander

Mrs. Beverly Arries
Patricia and Graham Barkhuff
M. Beverly and Robert G. Bartner
Elaine Baverman
Mr. and Mrs. Arne K. Berg
Harry and Harriet Bernbaum
Donald H. and Barbara K. Bernstein
Mr. Sidney Bernstein
Mrs. Robert W. Bingham
Francine Joyce Blum
Mrs. Elizabeth B. Booth
Mrs. Nina Bossert
Mr. and Mrs. James C. Bower Sr.
Donald Britt
Carol and Les Brualdi
Mrs. William N. Brune
Mr. and Mrs. George W. Burgess Jr.
Anne-Marie Cail, P.A.
Robert Cassidy
Mrs. Marion A. Chadduck
Douglas and Sharyn Chapman,
Charitable Remainder Unitrust
William E. Chapman II

Kevin J. and Helen V. Collins

Robert I. Collins

Alex and Cece Cooke

Carolyn Cooper

Mr. and Mrs. Brian Cornell

Thomas Coundit

Patti Ryan Cowan

Mrs. William O. Crittenden

Alida J. de Jongh

Joseph and Sharon Demmin
Mr. and Mrs. Richard O. Donegan
Lawrence P. and Carol M. English
Mrs. Richard A. Evans
Mildred R. Field
G. Duncan Finlay, M.D., and
Michele Wolk, MSN
Anne and Cope Garrett
Dr. Arthur and Toby Geller
Marian Y. Goble
Leila Gompertz
George and Ruth Haines
Mrs. Janet M. Hamann
Mr. and Mrs. Robert Hammer
Werner and Karen Hartenberger
Casiana and Barry Hilton
Allen and Stephanie Hochfelder
Verna M. Hoffman,
Charitable Remainder Unitrust
Doug and Carolyn Ann Holder
Betty S. Holmes
Patricia N. Holmes
Anonymous
Mr. Richard S. Johnson
Harriet V. Josenhanss
Mr. and Mrs. Steven H. Judd
Dr. Sidney Katz
John J. Kestly
Dr. and Mrs. Glenn F. Kiplinger
Mrs. Carol Krug

Moses and Pat Lane

Cherie L. Leetzow

Mr. Melville R. Levi

Dr. and Mrs. Marvin L. Lewin

Harold L. Libby and Wanda Rayle-Libby

Kathryn and James Liddell

Dr. Charles and Mrs. Lisa Loewe

Carol K. Longley

Madge Lumb

Flora Major

Walt Mannini

Adrienne J. Matcham

Allen D. McGee and Paula Norwood

Thomas F. McGuire

Robert A. Meaney

Joan Armour Mendell

Eileen Skehen Michala

Heather G. Miller, Ph.D.

Lois Rose Miles, Gift Annuity Fund

Shirley Rae Miller, Pooled Income Fund

Susan F. Milman

Mrs. Hortense L. Mintzer

Joel and Gail Morganroth

Loretta Naylor

Mr. and Mrs. William O. Nicoll

Anna Mae Pasqua

Deborah Poff and Valarie Clark

Rose Marie Proietti

Florence and Saul Putterman

Beverly R. Ricciardi

Mrs. Mary Ann Robinson

Mrs. Sandra Rollings

Harold R. Ronson

Jan and Susan Rubes

Mr. Brent Rugh

Mary and Buddy Savary

Mary Seymour

Mr. Bud Shapiro and Ms. Betty Lenz

Mrs. Ellen M. Sickmeier

Mr. S. Richard Silbert

Karam and Donna Skaff

Bill and Judy Stanford

Robert L. Stuffings

James H. Swartz

Jim and Charlie Ann Syrett

Richard Tamargo and Lisa Mateas

Marcia Jean Taub

Elizabeth T. Templeton

James and Susan Tollerton

Rebecca and Bill Tompkins

Mr. Thomas H. Towler,
Gift Annuity Fund

Mrs. Judy White

George M. Williams

Susan and Charles Wilson

Mr. and Mrs. Larry K. Winegar

Edie Winston

Margaret Wise

Marilyn Wolff,
Charitable Remainder Unitrust

Mrs. Stanley M. Woodhead





The Annual Gifts list includes those who made or pledged cumulative gifts of \$500 or more in the fiscal year 2021.

Annual Gifts

October 1, 2020 – September 30, 2021

VISIONARY \$10,000,000+

Brian and Martha Cornell

CAPITAL \$1,000,000+

Anonymous

Dr. and Mrs. Ralph W. Shrader

DISTINGUISHED \$500,000.00+

Mr. James C. Alexander

Mr. Jack Rohner

LEADER \$250,000.00+

Boscia Family Foundation

Teresa and Charlie Cannon

Eliza and Hugh Culverhouse

Deb Kabinoff

Jim Meekison and Carolyn Keystone

Anonymous

AMBASSADOR \$100,000+

Charles and Turner Broll

Betsy & Ed Cohen/Aretê Foundation

Kevin J. and Helen V. Collins

Steve and Lila Huse

Mr. Gary Jones

Jeffrey and Susan Jones

Victor M. Kaufman and
Elizabeth Ann Rainey

Kosloski Family Foundations

Judith H. Melly and L. Thomas Melly

Sam Samelson

Bill and Rebecca Tompkins

CHAMPION \$50,000+

Anonymous

Boar's Head Brand

Bohrer Family Charitable Foundation

Breast Health Sarasota, Inc.

Charles & Margery Barancik Foundation

Community Foundation of Sarasota
County

Kathy and Colin Cornhill

Louis and Gloria Flanzer
Philanthropic Trust

Mr. Melvin A. Gang

Mr. and Mrs. Franklyn Gorell

Mr. and Mrs. Howard Isermann

Michael V. Janes Non-Grantor Charitable
Lead Annuity Trust

Adrienne J. Matcham

Joel and Gail Morganroth

Ron Morris Family Foundation

Mr. Frank J. Rich

Gary and Barbara Rodkin

Mr. and Mrs. David M. Schneider

Sunset Automotive Group

Cheryl and Melvin Taub

Judi and Peter Wasserman

Jason & Nancy Wilson

PARTNER \$25,000+

John H. Barber and Myrtle F. Barber

Robert and Willa Bernhard

The Frank J. and
Lenora Dupuis Foundation

Mr. and Mrs. Paul F. Eckel

Dr. and Mrs. James Fiorica

Getzen Family Charities, Inc.

Bob and Joan Geyer

Mr. and Mrs. John R. Giglio

Mr. William A. Granberry

Mrs. Bernadine Haman-Sponzilli

Gregory and Carol Ann Kalish

Katherine M. Keeley, M.D.

Janice S. Kelly Memorial Foundation

Dr. Horace and Mrs. Lorrie Liang

Mr. Terry J. Lundgren

David and Susan Macrae

Richard and Diane Mayer Family Fund

Mr. and Mrs. Jonathan E. Mitchell

Northern Trust

Donald T. Regan
Charitable Foundation, Inc.

Samowitz Foundation

Elizabeth T. Templeton

Jackie and Glenn Tilton

James and Susan Tollerton

Michael and Karen Valentino

David and Monica Verinder

Jean A. Weiller

Elton and Gordie White

Bill and Cheryl Woeltjen

Judy Zuckerberg & George Kole

SUPPORTER \$10,000.00+

Robert and Shirley Adams

Drs. George and Janet Allgair

Ambitrans Ambulance

Anonymous

M. Beverly and Robert G. Bartner

Ralph Basile and Karen MacDonald-Basile

Mr. and Mrs. Walton Beacham

Brasfield & Gorrie, LLC

Dr. and Mrs. Richard H. Brown

Mr. and Mrs. William E. Chapman II

Chilmark Foundation

LeRoy Robert Dapper and
Susan Jane Dapper

Ariane Dart

Douglas Jeep Chrysler Dodge Ram

Dr. and Mrs. Mahfouz El Shahawy

Mildred R. Field

First Physicians Group of Sarasota

FLAD Architects

Florida Cancer Specialists &
Research Institute

Ms. Wendi Fogelson and Mr. Ed Mills

Gilbane Building Company

Mr. Hans M. Grainer

Gresham Smith

Mary Evelyn Guyton

Hillrom

Doug and Carolyn Ann Holder

Dr. and Mrs. Franz Hummert

Mr. and Mrs. Neil Hunn

Steven James and Karen Athena Lee

Arthur S. Karp Family Foundation, Inc.

W.K. Kellogg Foundation

Marcy and Michael Klein

Ruth B. Kreindler

LeeSar Regional Service Center

D.R. Long Foundation

Mr. and Mrs. Robert L. Loretan

Lung Associates of Sarasota

James and Lorna Mack

Manatee Community Foundation

Mr. and Mrs. Frank Martucci

Carolyn Michel and Howard Millman

National Emphysema Foundation

Anonymous
 Anna Mae Pasqua
 Stephen Della Pietra & Pamela Hurst-
 Della Pietra Family Foundation
 Radiology Associates of Florida, PA
 Mr. Robert and Dr. Sherry Rogers
 Eluned and Edward Russell Charitable
 Foundation
 Gail and Skip Sack
 SaraPath Diagnostics
 Sarasota Anesthesiologists, P.A.
 Mr. and Mrs. Joel Schleicher
 Lorraine and Richard Schwarz
 Family Foundation
 Mr. and Mrs. Steven B. Schwarzwaelder
 SHERLOQ Solutions
 Shutts & Bowen LLP
 Mrs. Ellen M. Sickmeier
 Eric and Doreen Spiegel
 Sutter Roofing Company of Florida
 Hobart and Janis Swan
 Jim and Charlie Ann Syrett
 Henry & Marilyn Taub Foundation
 Mr. and Mrs. Jonathan Uhrig
 Thomas and Ann Wierdsma
 Susan and Charles Wilson
 Peggy and Art Wood

SAMARITAN \$5,000.00+

Ravi and Virginia Akhoury
 APG
 B & I Contractors, Inc.
 Mr. and Mrs. Ali Bahaj
 Bank of America Charitable Foundation
 Banyan Pediatric Care Centers
 Mr. and Mrs. David I. Bavar
 Mr. and Mrs. Eugene H. Beckstein
 John and Christina Burns
 CAN Community Health

Arthur and Irene Cash Charitable Trust
 Mr. and Mrs. David Chaifetz
 Charles Perry Partners, Inc.
 Church of the Redeemer, Inc.
 Richard N. and Cynthia Clark
 Mrs. Kathleen R. Cocks
 Mr. and Mrs. Philip A. Delaney, Jr.
 Mr. and Mrs. Lewis Deutsch
 Mr. and Mrs. Bob DeVries
 Dex Imaging
 Lawrence P. and Carol M. English
 Frank and Christa Fineshriber
 First Horizon Advisors
 Mr. and Mrs. Harold Flynn
 Barbara Franke
 Mr. Ernest B. Garcia
 Mary Jean Glidden-Williams
 The Grain Family Foundation
 GrayRobinson, P.A.
 Renée Hamad
 Mr. Hal M. Hartle
 Dr. and Mrs. Jonathan D. Hoffberger
 Holcomb - Kreithen Plastic Surgery
 and MedSpa
 Sarah and Tramm Hudson
 IBERIABANK
 J2 Solutions Inc.
 Mr. Mikulas Janko and Ms. Yulia Kuzenko
 Johnson & Johnson
 Betsy and Bill Johnston
 Alexandra Jupin and John Bean
 Janet and Stanley Kane Foundation
 Drs. Thomas and Jacqueline Kelly
 Kerkering Barberio & Co., P.A.
 Mr. and Mrs. Michael J. Kovalcin
 Kramer Foundation, Inc.
 Frederick and Janet Leonberger
 Flora Major for the Kutya Major Foundation

Elizabeth C. Marshall
 Meisner Electric, Inc.
 Jim Meister
 Dr. and Mrs. Joseph Mendels
 Mr. John C. Metz
 Ms. Nancy Mina
 Keith Monda and Veronica Brady
 Mucha Family
 Mr. and Mrs. Julius A. Nicolai
 Richard and Betty Nimtz
 Mr. and Mrs. Mark Nordenberg
 Dr. Larry Press & Mrs. Lisa Keverian-Press
 RBC Wealth Management
 The Rogerson Family Foundation
 Alfred Rose
 Ronnie and Martin Sachs
 Sarasota Emergency Associates
 Sarasota Memorial Health Care System
 Sovereign Plastic Surgery
 Toby and Noel Siegel
 Mr. and Mrs. J. Ronald Skipper
 Sneed Family
 Mr. and Mrs. Zuheir Sofia
 Hillary Steele
 Sandi Stuart and Mike Murray
 Mrs. Iris Tabner
 Marcia Jean Taub
 Mr. and Mrs. Thomas L. Taylor
 Tiffany and Tommy Taylor
 Sally and Bob Theis
 Tidewell Hospice, Inc.
 Mr. and Mrs. James Parker Turner
 USF Federal Credit Union
 Pauline Wamsler
 Mr. Richard Webster
 Williams Parker-Attorneys at Law
 Mr. and Mrs. Ken Woodworth

FELLOW \$1,000.00+

1st Source Bank
 Mr. and Mrs. Ken Abt
 Affiliated Engineers Inc.
 Don and Peggy Jo Albertson
 The Allyn Foundation, Inc.
 Constance Andersen
 Anonymous
 Walter and Janet Aspatore
 Mason and Anne Ayres
 Kenneth and Claudia Bachman
 Dan and Nancy Bailey
 George Barrie Foundation
 Lisa Baumgardner
 Fran and Jamie Becker
 Mr. and Mrs. Thomas H. Belcher
 Melody Benoit
 Bentley Law Firm, P.A.
 Donald H. and Barbara K. Bernstein
 Bini-Scarborough Family Fund
 Irma Blumenthal
 Ms. Brenda Boelens
 William Bolling
 Bonitz Flooring
 Mr. and Mrs. Richard H. Booth
 Ms. Arminee Bowler
 Maria Bradley and Martin Pfister
 Ms. Lori Brand-Stall
 Audrey and Lewis Brazell
 Mrs. Jaclyn K. Brunckhorst
 Krista Byler
 Mr. and Mrs. Peter Calamaras
 CallisonRTKL Inc.
 Canandaigua National Trust Company
 Mr. and Mrs. John Cannistra
 Cardinal Health Foundation
 Mr. and Mrs. Walter K. Carlson

Cynthia Carr
 The Kathleen K. Catlin Foundation
 Douglas and Sharyn Chapman
 Mr. and Mrs. Thomas J. Charters
 Mr. and Mrs. Rich Clover
 Coastal Property Group of Florida, Inc.
 Louis H. Cohen, M.D.
 Dr. Rebecca Cohen
 Community Foundation of Louisville
 Mr. and Mrs. Philip Conover
 Mr. and Mrs. Kelvin Cooper
 W. David and Barbara C. Corbett
 Mr. and Mrs. Kenneth Cox
 Creative Contractors Inc.
 Chaplain Chuck Creech
 CryoXL
 Renee Cseresznye and Kelly Leone
 Susan Curran
 Anonymous
 Mrs. Carol B. Davenport
 Mr. Everett M. Davis
 Mr. and Mrs. George E. Davis
 DeAngelis Diamond Construction, LLC
 Maria DeCarlo
 Mr. Michael Delich and Ms. Denise Holter
 Sharon Wetzler DePeters and
 Joseph DePeters
 Jimmy Devellano Foundation
 Dimensional Insight, Inc.
 Robert E. Dods Family Foundation
 Mr. and Mrs. Richard O. Donegan
 Gary and Carol Dornbush
 Mr. David D'Ottavio
 Mr. and Mrs. Gregory P. Douglas
 Mr. and Mrs. William Douglas
 J.R. Edmiston
 Mr. and Mrs. Douglas Elder
 Ms. Annette Eliasberg

Brian and Caroline Ellerson
 Enterprise Holdings Foundation
 Envision Lighting Systems
 Janet and Denis Evans
 Financial Corporation of America
 First Physicians Group Neurology
 David and Ellen Flatow
 Mr. David Fouche
 Mrs. Andrea E. Frank
 Keith Franqueiro
 Fraternal Order of Eagles #2756
 Ladies Auxiliary
 Mr. and Mrs. Eugene F. Frost
 Ann and Larry Garberding
 Mrs. Dottie Baer Garner
 Dr. and Mrs. Kyle Garner
 George and Mary Ellen Gavagan
 Dr. Arthur and Toby Geller
 Valerie Gill
 Anonymous
 GMF Steel Group
 Dr. and Mrs. Michael Goldberg
 Mrs. Ruth Gorton
 Mr. and Mrs. Garry Goudy
 Mr. and Mrs. Mike Granthon
 Yulonda Greene
 Mr. and Mrs. Richard Hackel
 Ms. Beverly Harms
 David Harris Law PA
 Mr. and Mrs. Robert Hart
 Edna and Richard Hausman
 Ms. Sasha Hausman
 Ms. Jo Hennelly
 Alice Hicks
 Penny Hill
 Casiana and Barry Hilton
 Mr. and Mrs. Clinton Holdbrooks
 Anonymous

Drs. Kenneth and Wendy Hurwitz
 Infectious Disease Associates
 Infiniti of Sarasota
 George S. and Barbara Ives
 Rachelle Jackson
 Dr. and Mrs. Joseph Jacobson
 Jelks Family Foundation, Inc.
 Mr. Richard S. Johnson
 Harriet V. Josenhanss
 Mr. and Mrs. Charles E. Juengling
 David Jungst
 Mr. and Mrs. Richard Kalikow
 Mr. Eric S. Kaplan
 Lyn Kayser
 Knick's Tavern & Grill
 Mr. and Mrs. David Koffman
 Gerald A. & Karen A. Kolschowsky
 Foundation, Inc.
 Mrs. Joyce Koppel
 Ms. Judith Kozlowski
 Mr. Waldron Kraemer and
 Ms. Joan A. Lovell
 Krafur Family Foundation
 Mr. Charles Krahm
 Mrs. Elita Krums-Kane
 Peter and Madelyn Kujawski
 Anonymous
 Mr. and Mrs. Brian F. Landry
 Mr. and Mrs. James E. Lauritsen
 Ms. Vicki Leaden
 Mr. and Mrs. Martin R. Leader
 Mrs. Tina Lepore
 Mr. and Mrs. Bruce Lesser
 Mrs. Maryl Levine
 Louis and Sandra Levy
 Melvy Erman Lewis
 Stephen S. Lexow, M.D.
 Lilly Pulitzer

Mr. and Mrs. John Long
 Mr. Peter B. Lowndes
 Jean Marie Lucas
 Doug and Gwen MacKenzie
 Laura L. Magnusson
 Ticia Mahler
 Drs. Marguerite and T. Logan Malone
 Ms. Nancy Markle
 Drs. Jennifer and Peter Mayer
 Dr. and Mrs. Gus J. Mazzola
 Mr. Bob McAdoo
 Anonymous
 William and Elaine McClure
 Ms. Leslie Forkner McIntosh
 Mediscribes, Inc.
 Barbara Mei
 Robert, Maria and Donovan Milano
 Mr. J. William Misiura
 Dr. and Mrs. Frederick L. Moffat
 Frank Morgan
 Morgan Stanley Wealth Management
 Bill and Hope Morgan
 Eric and Judith Mower
 Mr. and Mrs. William Murgolo
 Drs. Alka and Deepak Nair
 Loretta Naylor
 Nemours Children's Health System
 Hannah and Frank Neubauer
 Mr. Bill Noonan and Ms. Bonnie McIntyre
 Mr. and Mrs. Alan Papernick
 Mrs. Andronike L. Passios
 David Patterson
 Mr. and Mrs. Jeffrey Paulsen
 Alisa and Roger Pettingell
 Mr. and Mrs. Doug Plattner
 Mrs. Beth B. Pocker
 Mr. Zac Potter

Theodore G. Probst, M.D.
 Rose Marie Proietti
 R1 RCM Inc.
 Thomas and Susan Radcliffe
 Pamela Ramhofer
 Dr. and Mrs. Henrik Rasmussen
 Raymond James
 Raymond James Financial, Inc.
 Mr. and Mrs. Tom Reilly
 The Reinhart Foundation
 Sharon and Bob Reitsch
 Mr. and Mrs. Edward W. Rhawn
 Migsie and Gar Richlin Foundation
 Britt and Noah Riner
 Randy and Cheryl Roberts
 Cheryl and Colin Robertson
 John Rodman, M.D.
 Mr. and Mrs. Leonard Rosenthal
 Mr. and Mrs. Gabriel Rosica
 Sharon Roush
 Mrs. Susan Ryan
 Ms. Patricia L. Ryland
 John and Marilyn Saba
 Ms. Natalie Salmore
 Dr. and Mrs. Russell H. Samson
 Sandy Family Foundation
 Anonymous
 Mary Ellen Scarborough
 Katharina and Joseph Schober Foundation
 Sally Schule
 Mr. and Mrs. Jack W. Schwarz
 Jeffrey E. Sell, M.D.
 Diane Settle
 Ted and Susan Sherman
 John & Catherine Shuler, Charitable Trust
 Howard and Marlene Shulman
 Mr. Morton Siegel

Karam and Donna Skaff
 Mr. and Mrs. Mark Spiegel
 St. Paul Lutheran Church
 Stantec Consulting Services Inc.
 Mr. and Mrs. Jim Stranberg
 Strategic Interests, LLC
 Michael and Robin Strauss
 Rene Sueiro, M.D.
 Suncoast Advisory Group
 Bibb and Pamela Swain
 Mrs. Charlie Ann Sypret
 Tampa Bay Trane
 Cindy Taylor
 Peter Taylor
 TLC Engineering Solutions, Inc.
 Greg and Lisa Totten
 Anonymous
 John G. & Anna Maria Troiano
 Foundation
 Turner Construction
 Ms. Carolyn Van Helden and
 Dr. Richard C. Rehmeier
 Ms. Lynette Velez Salheiser
 Monica Verinder - Michael Saunders & Co.
 Mr. and Mrs. Tony Vernon
 Ms. Clare Villari
 Joelle M. Vlahakis, M.D.
 Kimberly Walker, Esq.
 Walter Group Real Estate
 Elisabeth Waters
 Karen Wehner
 Ann C. Weingartner
 Mr. Charles S. Weiss
 Jeff and Tami Wesner
 Mrs. Judy White
 Martin Rometsch and
 Wilhelmine Wiese-Rometsch

Robb Wilburn
 Mr. and Mrs. William Wiltzie
 Angelia and Robert Wood
 Jon Yenari, M.D.
 Ms. Janice Zarro
 The Zelniker Dorfman Carr &
 Heritage Group
 Mr. Aldo C. Zucaro

FRIEND \$500.00 +
 Elizabeth Ackroyd
 Barbara and Stuart Aferiat
 Kara Altice-Montes
 Anonymous
 Anonymous
 Mr. Christopher R. Antoniaci and
 Ms. Phyllis E. McGrady
 Ms. Catherine Bachand
 Carol Noah Banach
 Mr. and Mrs. George Barletta
 Ms. Linda Baum
 Mr. Chris Beck
 Paul and Pam Beitlich
 Deborah Bellas
 Mr. and Mrs. Arne K. Berg
 Mr. Stewart B. Beyer
 Mr. Larry Blackburn
 Francine Joyce Blum
 Mr. Read Blumberg
 Boca Grande Health Clinic Foundation
 Jennifer Bonamer
 Martin and Barbara Bowling
 Debbie Brown
 Mr. Robert J. Buschman
 Tara Butler, M.D.
 Joyce and Van Carlisle
 Israel Carrasquillo-Cruz
 Terry Cassidy

Judy Ann Cavallaro
 Cave Wealth Management
 Mr. and Mrs. Lee Chaplin
 Mr. and Mrs. Steven Cohen
 Taylor Collins, CLU
 Teresa Collins
 Mr. and Mrs. Richard Conder
 Ms. Jennifer H. Cooper
 Thomas Coundit
 Mrs. Francie Cowen
 DeWayne Cusick
 Barbara B. Dearborn
 Mr. and Mrs. John P. Deckro
 Mr. and Mrs. Stephen Delman
 Mr. Daniel J. Denton
 Mr. and Mrs. Herbert A. Dickinson II
 George and Fran Dietz
 Christine Donnelly
 Chelee Eaton
 Peg Elbare
 Cathy and David Emmett
 Julie Ennis
 Ms. Frances Evans
 Mr. Jonathan Fleece
 Dr. Bruce and Ruth Fleegler
 Florida West Coast Bead Society
 Dr. and Mrs. Jonathan C. Fong
 Mario Gallo
 Jackie Garabito
 Mr. and Mrs. Thomas Gardner
 Anne and Cope Garrett
 Coworkers of William Genneken
 Mr. Charles S. Gentsch
 Maria Georgiev, M.D.
 Richard and Abby Gerrity
 Ashley A. Grant, D.O.
 Kimberly Gray

Mr. and Mrs. Donald Grierson
 Susan Grimwood
 Dr. and Mrs. Marc A. Grinberg
 Mr. and Mrs. Jim Harding
 Anonymous
 Robert and Deborah Hendel
 Anonymous
 Ms. Laura Horner
 Mrs. Arcine Hovanessian-Hermiston
 Lisa Hymel
 Mr. Steven Jackson
 Mr. and Mrs. Paul Jacobs
 Sue Jacobson
 Jewish Federation of Sarasota-Manatee
 Karen Johnson
 Mrs. Frances C. Jones
 Anonymous
 Suellen Kaeb
 Mr. Scott Keeler
 Ms. Janna Kim
 Mr. and Mrs. William L. Kimbell Jr.
 Mr. and Mrs. Michael Klauber
 Ms. Muriel M. Klein
 Mrs. Sandra R. Kligman
 Cheryl Klosterman
 Anonymous
 Mr. Steven Kourelakos
 Dr. Stephen Kucera and
 Dr. Jennifer Kucera
 Iris La Joie
 Mrs. Fran Lambert
 Mr. and Mrs. Everett Lanthier
 Laurie LeBoutillier
 J.D. Ledbetter
 Dr. Barry Levin and Mrs. Evelyn Levin
 Christopher S. Little, M.D.

Elliot and Carol Livstone
 Mrs. Sarah Lodge, CFP
 Mrs. Barbara Fischer Long
 Anonymous
 Joan R. Lyon
 Carol L. Lyons
 Judy Mack
 The Mall at University Town Center
 Mr. and Mrs. J. Richard Matson
 Larry C. Matsumoto, M.D.
 Ms. Heather Mays
 Kimberly McCloughan
 Ms. Patrice McDaniel
 Mr. Henry O. McFarland
 Bart and Shawn McKee
 Aimee Miller
 Madelle Miller
 Mr. Robert C. Miller and
 Mrs. Diane R. Turnier
 Mr. William L. Milligan
 Mr. and Mrs. Fred S. Missad
 Mike Mitchell
 The Moravits Family Foundation
 MSP Digital Marketing
 Danne and Tish Murphy
 Joy Nelson
 Ms. Frances Nitschke
 Sue and Rich Olsen
 Joannie Padgett
 Mr. John C. Patterson and
 County Commissioner Nora Patterson
 Mark Pellman
 Ms. Kay Perrin
 Bobby and Aly Pettit
 Lee and Kathie Pokoik
 Julie Polaszek
 Susan Pringle

Jennifer Prinkey
 Eric and Jana Putnal
 Mr. Earl R. Quandt
 Mrs. Kelly S. Quigley, P.A.
 Laura Quinn
 Mr. and Mrs. Zachary Rans
 Walter and Therese Reichert
 The Renewal Point
 Mrs. Barbara Rodkin
 Mr. and Mrs. Bruce Rosenberg
 Mr. and Mrs. Alan J. Ross
 Mrs. Elaine Rothenberg
 Mr. Joseph I. Rue
 Phares B. Rutt
 Joanna L. Sabol
 Sarasota Retina Institute
 Mr. and Mrs. Robert Schaal
 Mr. and Mrs. Frederick A. Schenck
 Saralou Butler-Schierloh
 Anonymous
 Jeff and Alexis Sergi
 Mr. and Mrs. Mark J. Sharff
 Mrs. Stephanie L. Shaw
 Ms. Alyssa Simons
 Dr. and Mrs. Joseph D. Singer
 SKY Family YMCA
 Mr. and Mrs. B. Thomas M. Smith Jr.
 Trude Smith
 Jessica E. Snyder
 Spirit Movers
 Dr. and Mrs. Walter J. Stark
 The Starling Group
 Ms. Stefanie Steel
 Dr. and Mrs. Barry I. Stein
 Don Stitt
 Jennifer Storch

Mr. Brian Sullivan
 Mr. and Mrs. Stephen Sutter
 Anonymous
 Dr. Sarah Temple and
 Dr. Angus Mugford
 Matthew Thomas, M.D.
 Tonia and Rodney Thompson
 Thomas and Janice Tomlinson
 Ken Trotter
 Mr. Daniel E. Vigne, CFP
 Cam Watt
 Mrs. Edris Weis
 Anne and Martin Welch
 Stan and D'Ann Wernick
 Mr. and Mrs. David C. Wertheimer
 Dr. and Mrs. Charles P. Wilkinson
 Mr. John Yoder
 Keisha Young
 Mr. Brad Zabel



Together we strengthen healthcare.

Sarasota Memorial Healthcare Foundation is the philanthropic partner that helps Sarasota Memorial Health Care System bring world-class healthcare to our community. For over 45 years, the Healthcare Foundation has provided grants to enhance patient care, facilities and technology, and to support ongoing clinical education and medical research.



941.917.1286 | smhf.org

Every effort has been made to ensure the accuracy of these lists of names. If an error has been made, please notify the Healthcare Foundation and the necessary corrections will be made.